

# PLASMA 100 TGE

## 60% DUTY CYCLE

**100A**  
Thriphasic



Pure copper 2m



LT 100  
6 m

### Advantages:

- Advanced inverter system for professional Plasma metal cutting.
- Ready for a quick and clean cut of all kind of metals and alloys.
- Manufactured to be used in severe service industrial environment in metal constructions, boilermaking and repairs.
- No rival quality to price relation: 100A at 60% duty cycle.
- Easy cut, even for non experienced users, due to the ST WELDING clever logic.
- Includes high quality pressurized air regulator and filter with manometer gauge.
- Extra strong carpentry in metal sheet with internal reinforcement and metal cast.
- Advanced design and quality electronic components, including high performance HF conmutators & rectifiers, toroidal power HF transformers and first brands components including (Philips, Motorola, APT and Ixys) oversized for maximum durability and safety.
- Withstands inputs of 470.
- Ready for all kind of stabilized generators with capacitor, AVR or Inverter regulators.
- Solid manufacture, under European regulations 2014/35/EU, 2014/30/EU and IEC 60974.

### Includes:

- Main input cable. Pure copper. 2m x 2.5mm<sup>2</sup>
- Ground cable with clamps. Pure copper. 2m x 16mm<sup>2</sup>
- Plasma Torch (PLASMA 100 TGE) LT 100 - 6m

All accessories available in our catalogue

### Features

	PLASMA 100 TGE
Current (A, X=60%)	100
Cutting depth (mm)	32
Mass (kg)	30
No load voltage (V)	3 x 400
Power Generator (KVA)	11
Dimensions (cm)	62x32x50



Área Empresarial Andalucía Sector 1  
Calle Sierra de Cazorla, 7  
C.P. 28320 Pinto (Madrid) Spain  
Tel: + 34 91.691.86.30  
info@grupostayer.com

# Configuration scheme LT-100 PLASMA TORCH

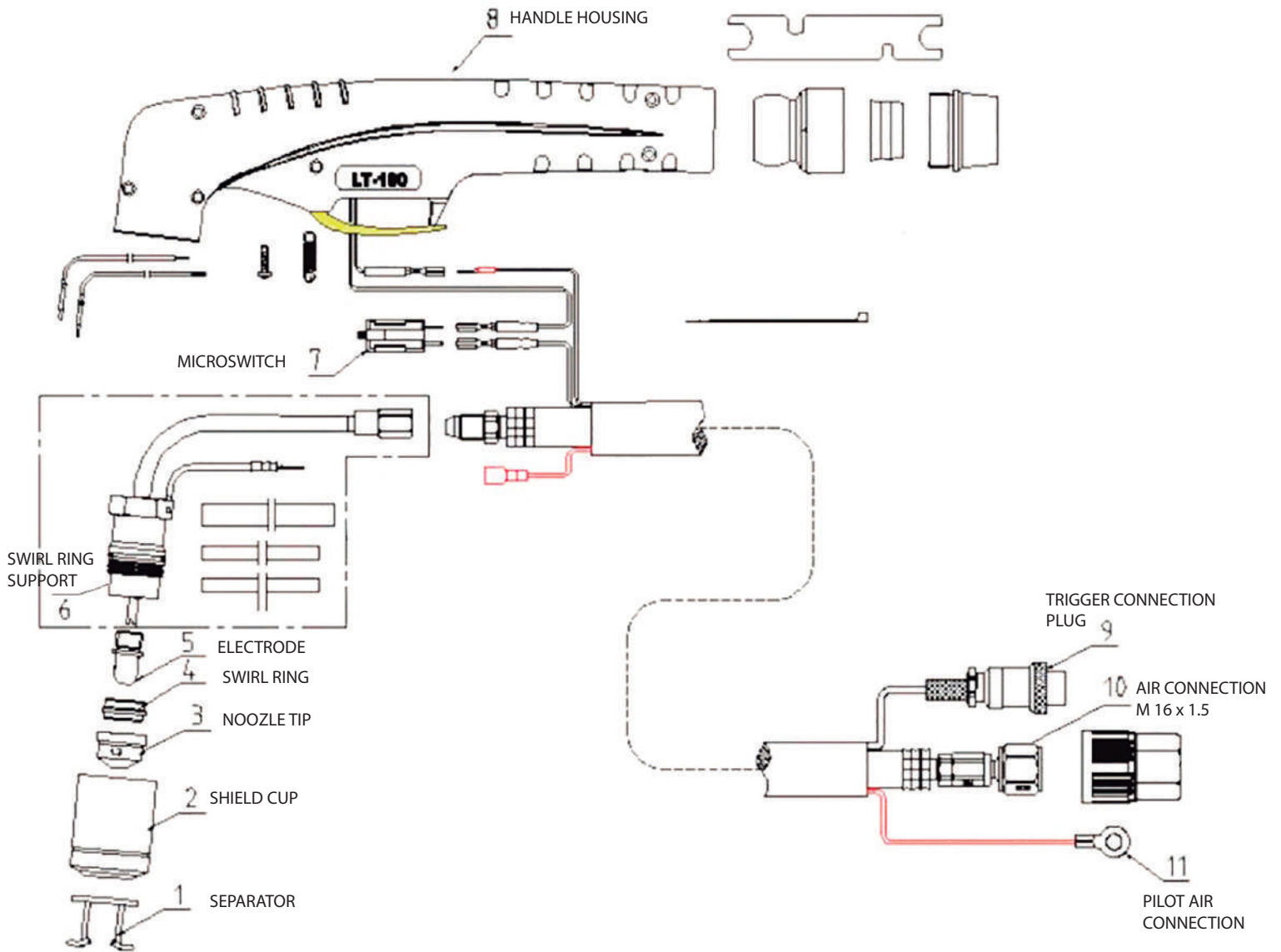

# STAYER PLASMA 100 T GE

Invertorski uredjaj snage 100 A za plazma sečenje komprimovanim vazduhom svih elektroprovodnih materijala do debljine 32mm.

U robustnom kućištu, pripremljen za maksimalna opterećenja u najtežim radnim uslovima

Krajnje jednostavno podešavanje preko ugrađenog regulatora sa manometrom za protok vazduha

Pripremljen za napajanje preko agregata - GE

Ukupna masa uredjaja - 30,0 kg

U saglasnosti sa Evropskim specifikacijama: 2014/35/EU, 2014/30/EU i IEC 60974.

Isporuka obuhvata osnovni uredjaj na sopstvenoj platformi sa točkovima, napojni kabl, kabl za masu sa priključkom i plazma gorionik LT 100 sa polikablom dužine 6m

**Garancija: 2 godine** - Servis i rezervni delovi su obezbedjeni – **Galeb Group / Galeb System**

## TEHNIČKE KARAKTERISTIKE

Maksimalna radna struja	100 A
Maksimalni prečnik sečenja	32 mm
Intermitenca na 40°C	
Pri 60% opterećenja	100 A
Napon	400V 3-ph
Tolerancija ulaznog napona	470V 3-ph
Angažovana snaga pri napajanju preko agregata	11 kVA
Dimenzije (D x Š x V)	620 x 320 x 500 mm
Masa	30,0 kg

Info: [www.galeb.com](http://www.galeb.com)

E-mail: [info@galeb.com](mailto:info@galeb.com)

Tel: 015/367-700